

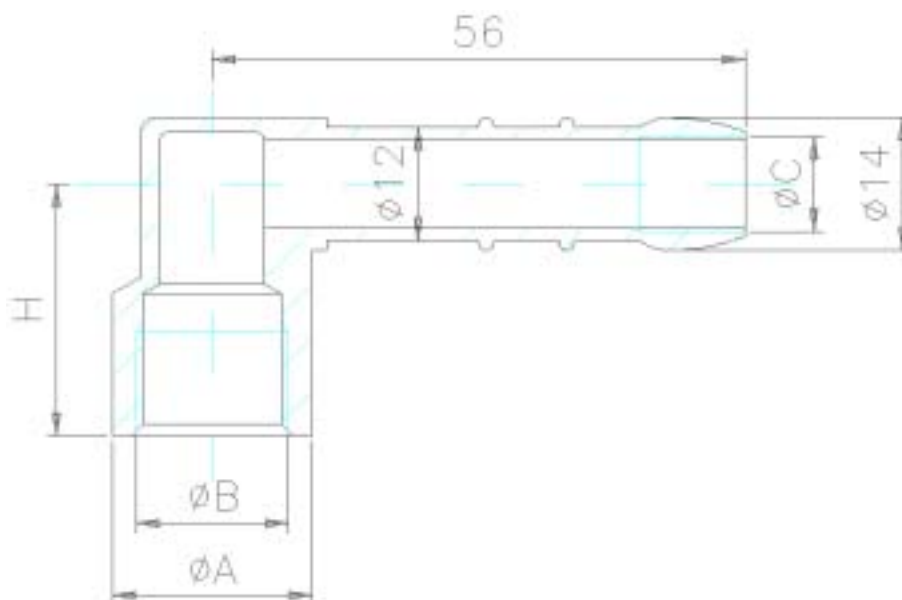

Portagomma ad angolo 13 IMQ in ALLUMINIO (maschio - femmina)

Portagomma in ALLUMINIO UNIEN AB 46100.
Conforme alle normative UNI 7141.



Rif. UNI-ISO 228/1 Filett. GAS cilindrica
UNI-ISO 7/1 Filett. GAS conica
UNI 5699 Filett. METRICA

Scritta in rilievo 0.3mm H.4mm "13"
Marchio IMQ-UNICIG 
Marchio Press. SEBINE 
Numero di impronta

Codice articolo	N. di disegno	ϕA	ϕB	ϕC	H	Ch.			Note
010.0472.0.00	02031100	20,8	3/8" Gas	M10x0,75	26,5	17			Femmina
010.0473.2.00	02018800	1/2" Gas	14,1	M10x0,75	21	17			Maschio
010.0475.0.00	02031200	3/8" Gas	10,2	8,8	24	17			Maschio
010.0889.2.00	02018801	1/2" Gas	14,1	1/8" Gas	21	17			Maschio
010.0104.2.00	02025400	1/2" Gas	12,4	1/8" Gas	21	17			Maschio
010.0470.2.00	02025401	1/2" Gas	12,4	M10x0,75	21	17			Maschio
010.1275.2.00	02056800	3/8" Gas	10,2	M10x0,75	24	17			Maschio